

Low Cost Linear Motion Products

i-SLIDE



**Linear motion products using high precision
miniature ball bearings**

Linear motion products using high precision miniature ball bearings

Preload structure and moves smoothly without looseness.

Ball bearing type Linear motion products with excellent low noise.

Feature

- Six high-precision miniature ball bearings are used.
- No looseness between slider and rail by preload design.
- Apply to sliding part with light load.
- Smooth movement is realized by rotating bearings.
- Simplified design for easier mounting to various machineries.
- There are 3 types of rail width.



25SW Series

Type No.	Main Dimension		
	Rail Length (L)	Stroke	No. of fixing Holes (n)
25SW0160SS	160	92	2
25SW0240SS	240	172	3
25SW0320SS	320	252	4
25SW0400SS	400	332	5
25SW0480SS	480	412	6
25SW0560SS	560	492	7
25SW0640SS	640	572	8
25SW0720SS	720	652	9
25SW0800SS	800	732	10
25SW0880SS	880	812	11
25SW0960SS	960	892	12
25SW1040SS	1040	972	13
25SW1200SS	1200	1132	15

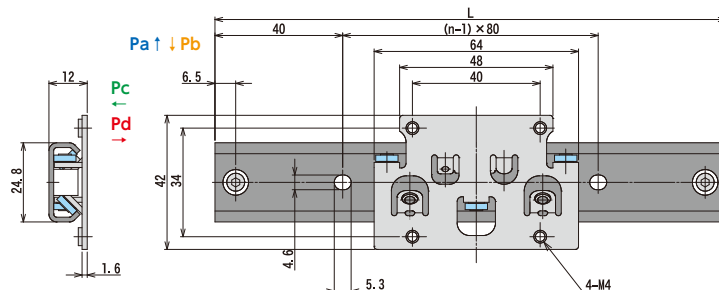

Static load capacity(N)

Pa	Pb	Pc	Pd
50	100	200	100

Components and Material

Rail	SUS430
Ball Bearings	13Cr Stainless
Slider	SECC+Electroless nickel plating

■ 37SW Series

Type No.	Main Dimension		
	Rail Length (L)	Stroke	No. of fixing Holes (n)
37SW0300SS	300	206	3
37SW0350SS	350	256	4
37SW0400SS	400	306	4
37SW0450SS	450	356	5
37SW0500SS	500	406	5
37SW0550SS	550	456	6
37SW0600SS	600	506	6
37SW0650SS	650	556	7
37SW0700SS	700	606	7
37SW0750SS	750	656	8
37SW0800SS	800	706	8
37SW0900SS	900	806	9
37SW1000SS	1000	906	10
37SW1200SS	1200	1106	12

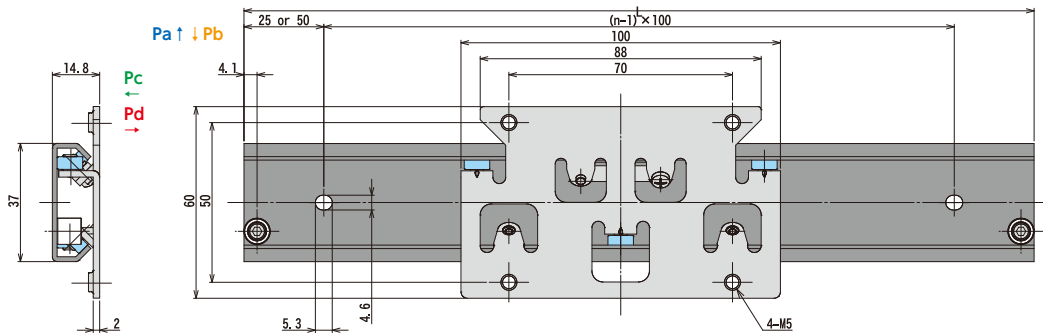

Static load capacity(N)

Pa	Pb	Pc	Pd
120	175	350	245

Components and Material

Rail	SUS430
Ball Bearings	SUJ2
Slider	SPCC+Electroless nickel plating

■ 20SW Series

Type No.	Main Dimension		
	Rail Length (L)	Stroke	No. of fixing Holes (n)
20SW160SSN	160	92	2
20SW240SSN	240	172	3
20SW570SSN	570	502	7

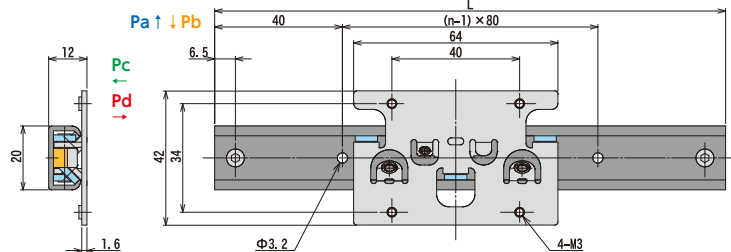

Static load capacity(N)

Pa	Pb	Pc	Pd
50	100	200	100

Components and Material

Rail	SUS430
Ball Bearings	13Cr Stainless
Slider	SECC+Electroless nickel plating

Due to the structure of this product, the load or moment load may cause looseness

■ Product Performance Data

Each result is for internal verification and is reference data only.

Slider surface height

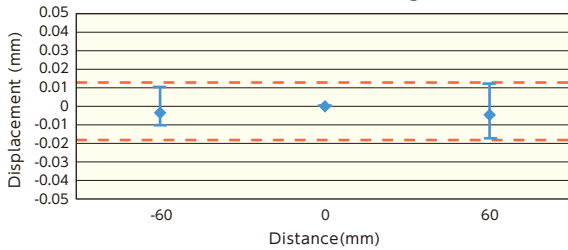

Measure the height when shifted 60 mm, based on slider is at the center of the rail.

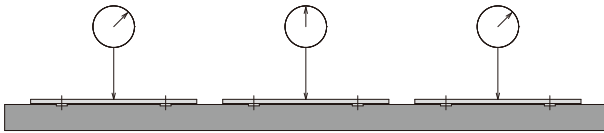

Stiffness Test Data

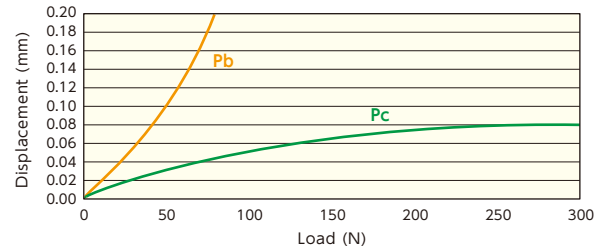

Able to use any direction, however Pc direction is recommended, since high stiffness at Pc direction.

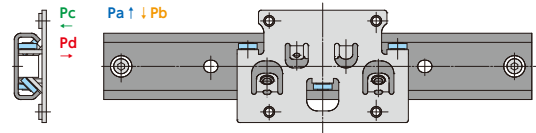

Durability Test Data (Horizontal Placement)

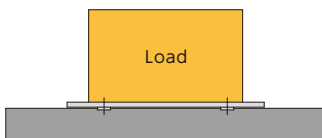
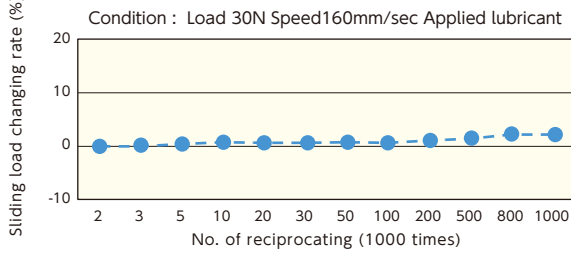

Sliding load is stable after 200km running.

Noise Level Test

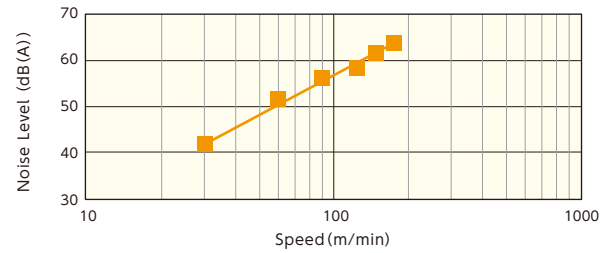

- Product: 25SW0560SS
- Test Direction: Horizontal (Slider Upward)
- Lubricant: Applied
- Mic Height: 500mm from Slider upper surface
- Noise level is about 57dB, at moving speed 100m/min

[Cautions when using]

- Lubricants on roller running surface are needed. Please lubricate properly.
- Do not dismantle each parts. It may cause loss of function.
- Do not drop, knock **i-SLIDE**.
- Be careful to get in particles such as dust, metal chips into roller running surface.
- Do not use under water, particles, other than normal temperature and extreme reciprocation that is able to generate frictional heat, It may cause damage or loss of function.
- Slowly insert slider when re-assemble it after remove from rail, and take note that preload will be changed if insert slider into rail with different direction.
- Visit our website for latest information.

NSK Micro Precision Co., LTD.

<http://www.nskmicro.co.jp/>

Head Office, Sales Division 6F Hirose Bldg., 3-17 Kanda-nishiki cho, Chiyoda-ku, Tokyo 101-005
TEL:03-5283-7420 FAX:03-5259-0882

Osaka Sales Office 5F OMM, 1-7-31 Otemae, Chuo-ku, Osaka, 540-6591
TEL:06-6942-0858 FAX:06-6941-9113

Matsumoto Sales Office (In Matsukawa factory) 2953 Moto-oshima Matsukawa-machi,
Shimo-Ina gun, Nagano Prefecture, 399-3303
TEL:0265-48-6022 FAX:0265-48-6023

※Contents may be revised without prior notice.